

MEMORANDUM FOR THE
CHILMARK, MA

K.A. HEALY 6/28/19
WEST TISBURY MA
PEMA 23498

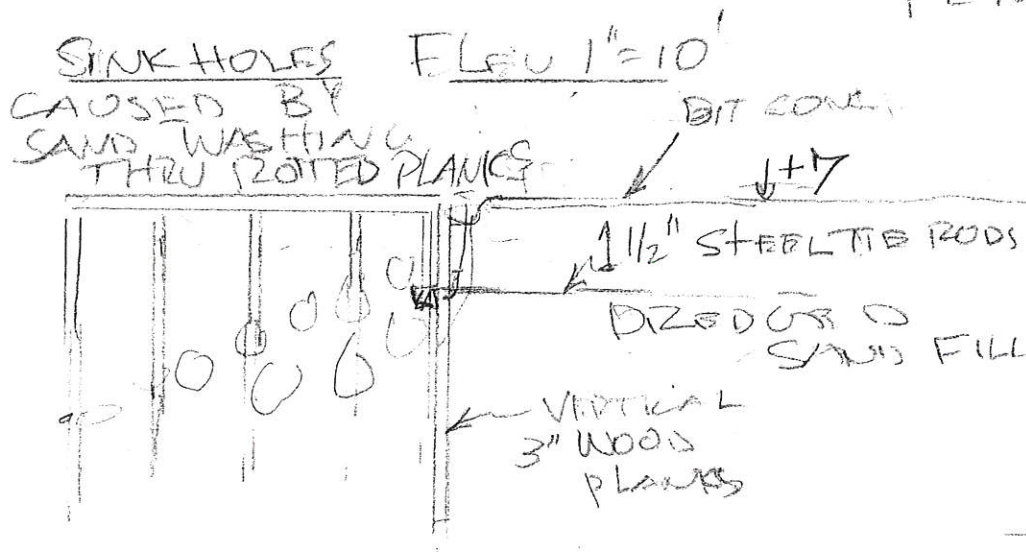

OPTIONS TO PREVENT SINK HOLES

1. FILL DEPRESSIONS EVERY SPRING WITH
a) CONC. b) BIT. CON. c) GRAVEL
2. DRIVE 10' #4 REBARS VERTICALLY 4" APART
ON INSIDE OF WOOD PLANKS
3. DRIVE FLAT SHEET PILING
ON INSIDE OF PLANKS
4. DRIVE Z SHEET PILING
ON OUTSIDE OF WOOD PLANKS



MENEMSHA PIER
CHILMARK MASS

ESTIMATE OF COST OF 20' x 150' PIER

KA. HEALY
8/1/97
WESTTUSBUCK MA
DE MASS # 20498

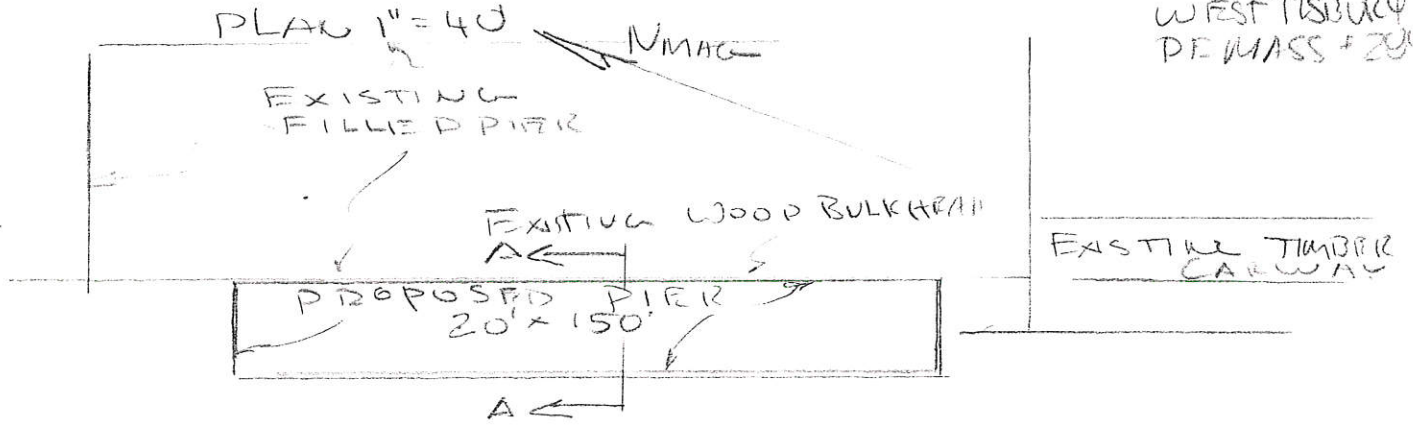

1. CANTILEVERED ZP38 SHEET PILING W/ SAND FILL

A-A 1" = 10'

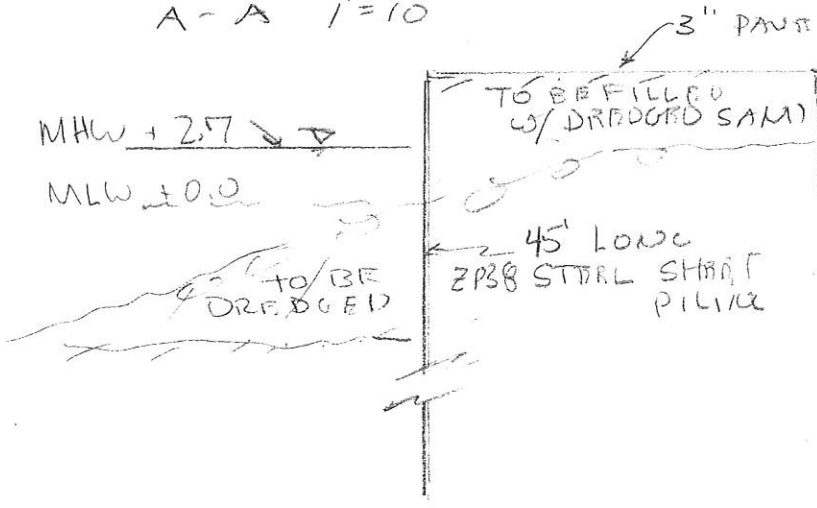

- 6 PLACE 190' x 45' ZP38 @ 20¢/ft² - \$ 170,000
 - 2. DREDGING @ 200 yd³ @ 10¢/yd³ - 2,000
 - 3. SHEETING CAP 3000
 - 4. 3000 FT² 3" PAVEMENT @ 1.50¢/ft² 4500
- \$ 179,500

2. TIMBER PIER ON 30' DREDGED WOODPILES

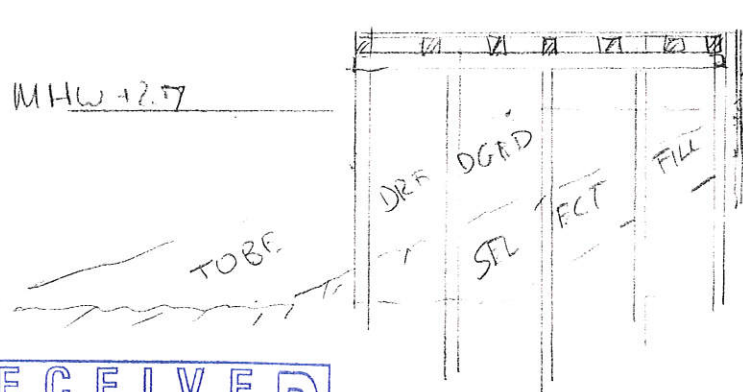

- 1. CONSTRUCT H=20 3000 FT² TIMBER PIER @ 45¢/ft² - \$ 135,000
 - 2. PLACE 1000 YD³ OF SELECT ROCK FILL TO HOLD EXTG BULKHD @ 50¢/yd³ 50,000
 - 3. DREDGER + SPOIL 1300 YD³ @ 5¢/yd³ 7000
- \$ 192,000

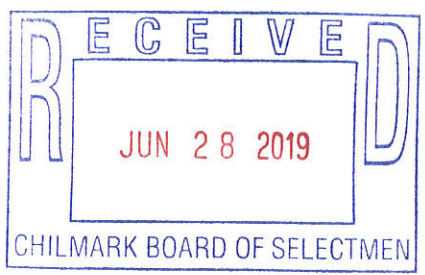

10 WNOF CHILMARK, MASS.
 150'x20' TIMBER PIER IN MENEHANS HA CREEK
 REVISIONS + ADDENDA

KENT A. HEALY
 4/15/99
 WEST ISBURY, MASS
 FE MASS #29498



PILE PLAN 1"=20

16- 4 PILE BENTS

PILES DRIVEN TO
 ELEV -22' (29ft BELOW
 DECK ELEV.)

8 BATTER PILES
 DRIVEN TO ELEV -22

16- FENDER PILES
 DRIVEN TO -22

8- 12"x12"
 STRINGERS

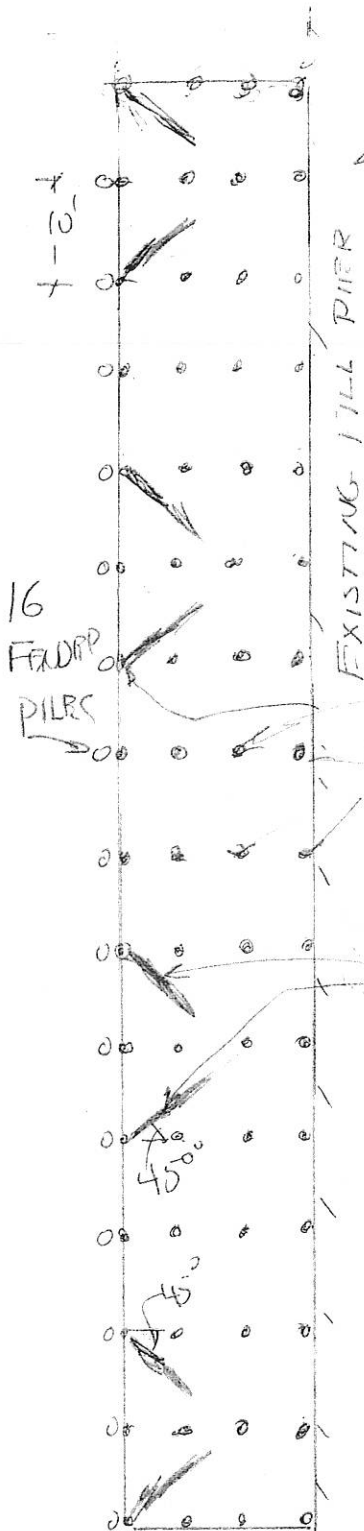

16
 FENDER
 PILES

EXISTING TILL PIER

VERTICAL
 PILES

BATTER
 PILES

1 HORIZ
 TO 3 VERT.

+13 - ELEV.

-8 -

+7
 EXT
 TO
 PIER

-22

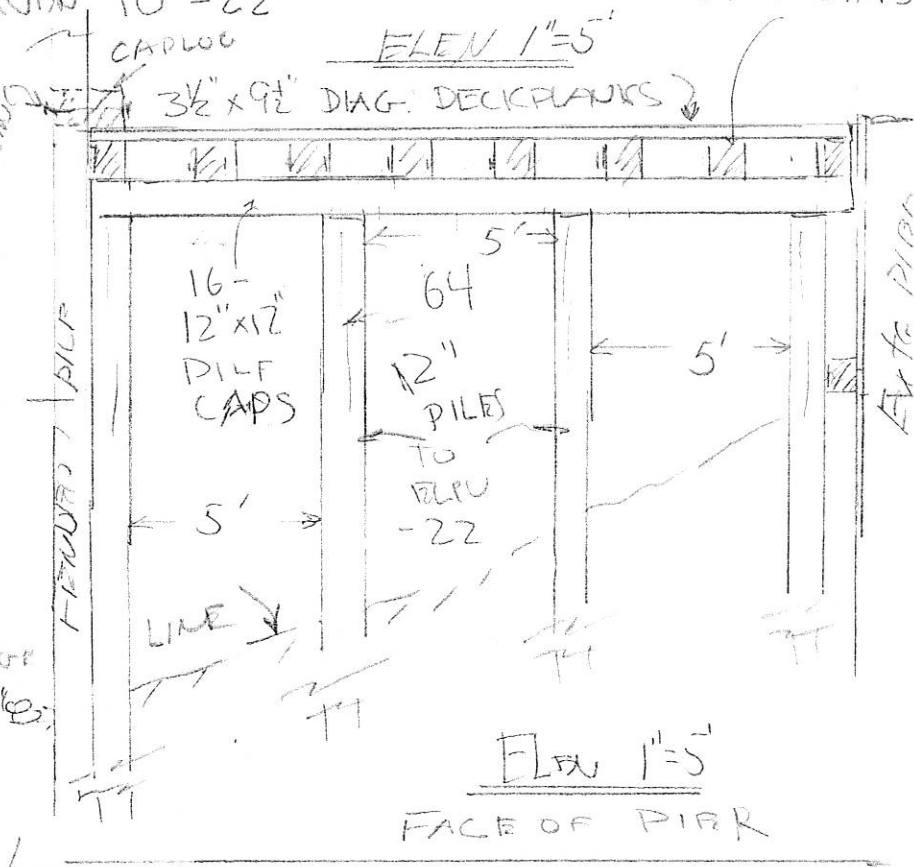

CAPLOG

ELEV 1"=5'

3 1/2" x 9 1/2" DIAG. DECK PLANKS

16-
 12"x12"
 PILE
 CAPS

12"
 PILES
 TO
 ELEV
 -22

ELEV 1"=5'
 FACE OF PIER

STRINGER

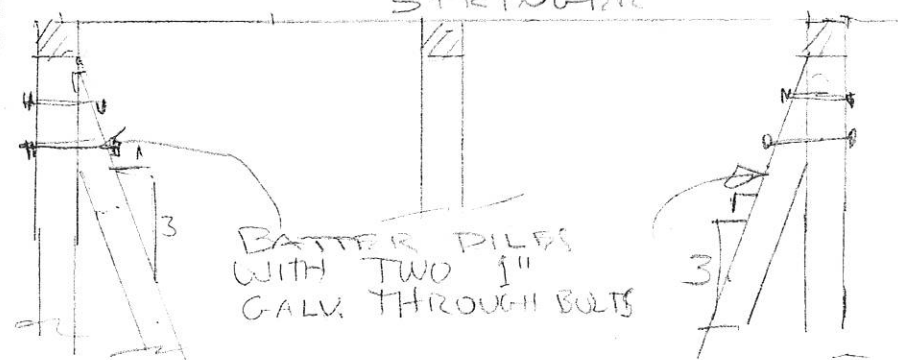

BATTER PILES
 WITH TWO 1"
 GALV. THROUGH BOLTS

MENEMSHA

TIMBER WHARF

K.A. HEALY
9/16/98

PLAN 1" = 5'

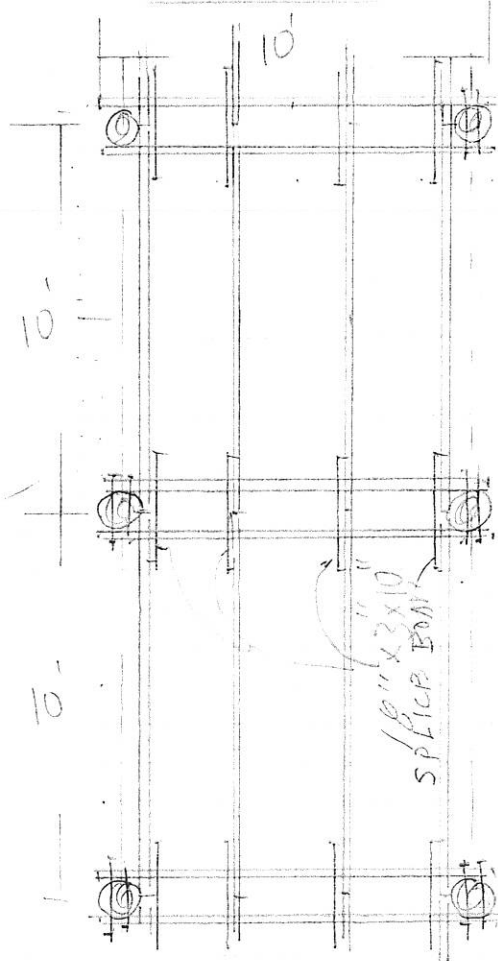

ELEV 1" = 5'

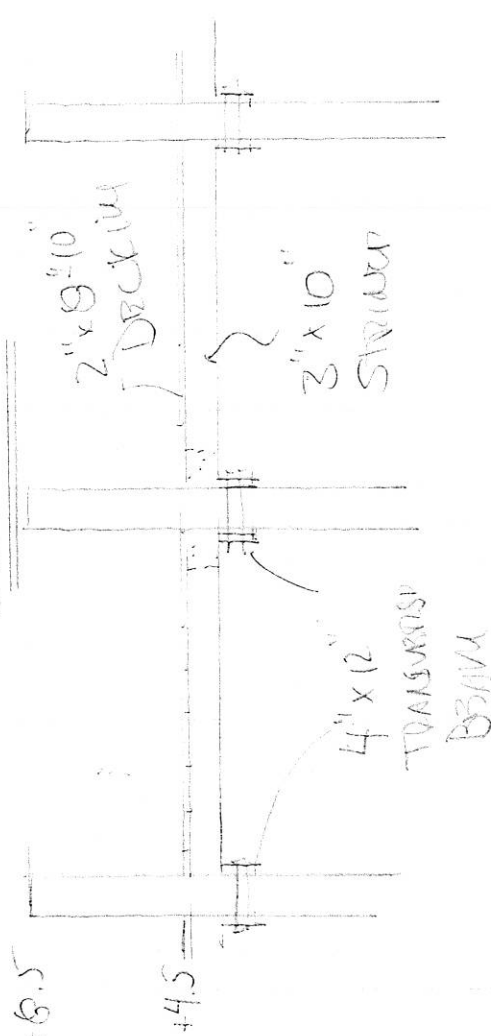

ELEV 1" = 5'

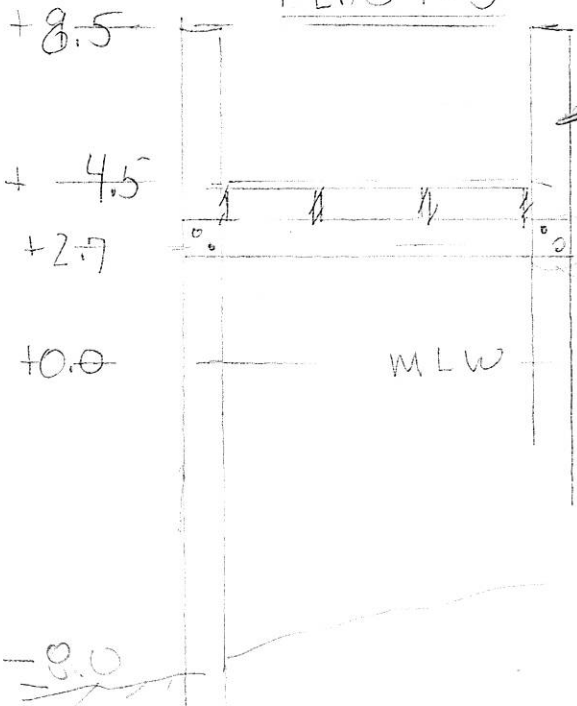

30' LONG PILES
 JETTED TO FLP -20'
 DRIVEN TO FLP 21.5'

M.H.W. +2.7

2- 1" GALV BOLTS

M.L.W.

+0.0